

RECOMMENDATIONS FOR INSTALLATION: INDOOR GLUES

MEMBRANE CONNECTION TO WALL - CONCRETE

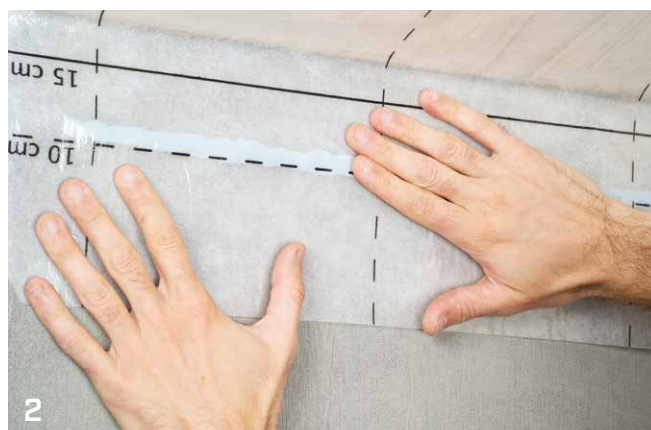

MEMBRANE CONNECTION TO ROOF - CONCRETE



MEMBRANE CONNECTION TO ROOF - OSB



MEMBRANE OVERLAP SEALING

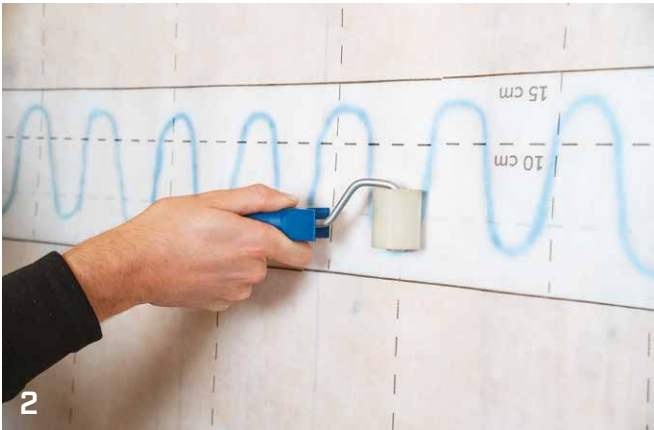
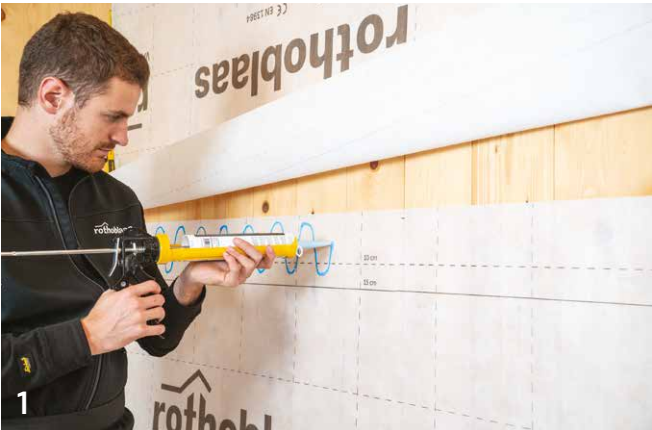

WINDOW HOLE SEALING



1 PLASTER BAND LITE

MEMBRANE CONNECTION TO WALL - CONCRETE



1 PRIMER, PRIMER SPRAY