

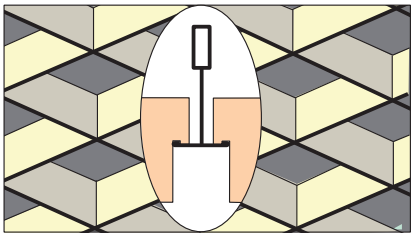

NordProfil

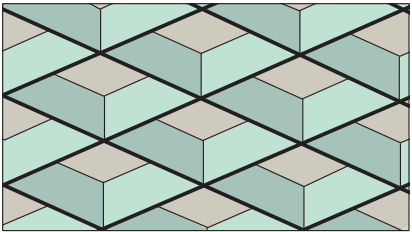

Multicel C

CONCEALED FIXED METAL
OPEN CELL LOUVRED CEILINGS

Multicel R

REVEAL JOINTED LAY IN METAL
OPEN CELL LOUVRED CEILINGS

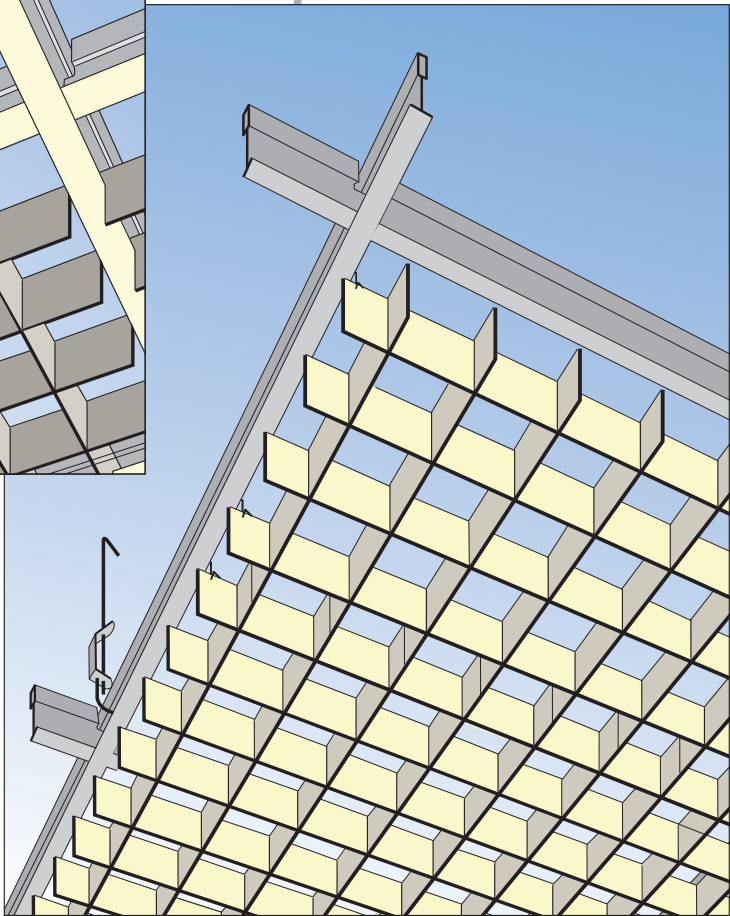
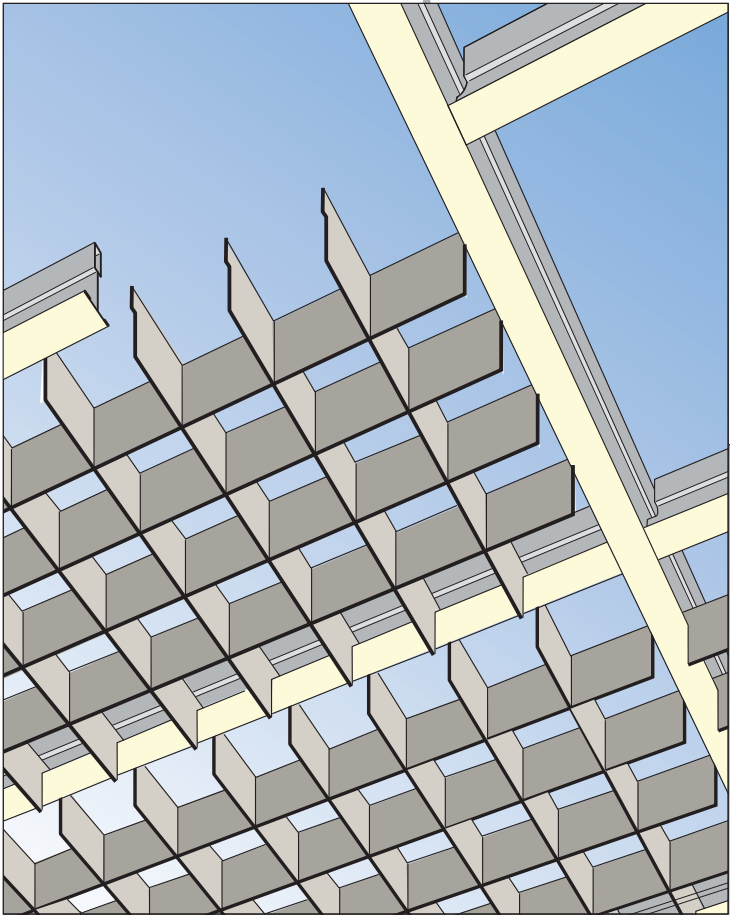

**Nord Profil Deutschland
GmbH & Co. KG**

Meteler Stiege 51-57
48565 Steinfurt
Germany

Tel.: (+49)-2551 864 600
Fax: (+49)-2551 864 6020
E-mail: info@nordprofil.com
Internet: www.nordprofil.com

1

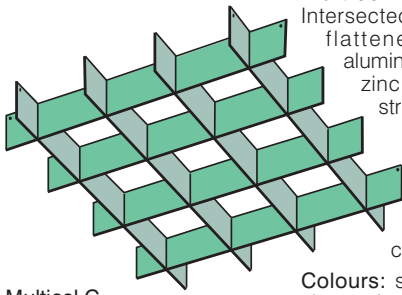

Multicel C

Multicel C & Multicel R
Intersected single blades of
flattened 0.5mm thick
aluminium or 0.4mm thick
zinc coated mild steel
strip.

Standard finish:
stove enamel
polyester paint in
matt, semi-gloss or
full gloss (see
colour chart).

Colours: standard as colour
chart no's
30 traffic white (RAL 9016)
(steel)
901 White RAL 9010 (steel)
117 clear lack (Alum.)

Special finishes: subject to
minimum order quantity

Standard sizes: 600 x
600mm Multicel C15
or Multicel C24 or
600 x 1200mm
Multicel C15 or
Multicel C24,
blade height to
order (see Table 1)
supplied pre-
assembled

Standard cell sizes: shown in
Table 1

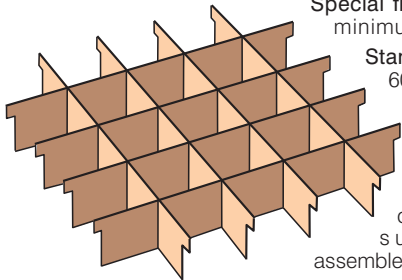

Multicel R

1A

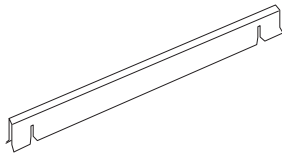

Multicel C only: 10mm deep x
(20mm + cell width) long in
same material, thickness and
finish as (1).

2i

Note: 2i, 2ii, 2iii are all cold
rolled tee sections
manufactured from 0,38mm
thick hot dipped galvanised
mild steel of commercial prime
quality, hem capped with
0.3mm thick predecorated
steel.

Note : 2i only.

Stalk cutouts and hanger holes
centres 100 mm

Standard finish:
Black (Multicel C)

White 901 or
silver metallic
18 (Multicel R)

**Standard
length:**
3000mm

Overall size: 15 or 24mm wide
x 37mm deep.

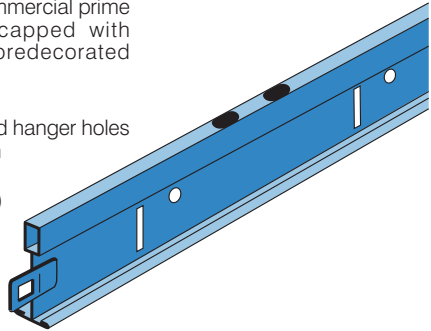

2ii

Note: 2ii only: Central cutout
in stalk

Standard finish: as (2i).

Standard length: 1200mm
nominal

Overall size: 15 or 24mm wide
x 37mm deep.

2iii

2iii Multicel R only:

Standard finish: as (2i)

Standard length:
600mm nominal

Overall size: 15
or 24mm wide
x 37mm deep.

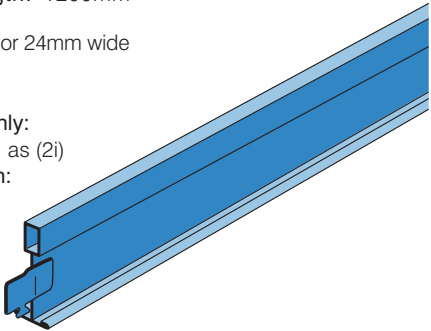

2A

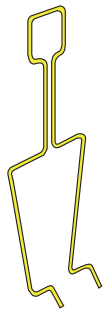

Multicel C only
Alternative 1.0mm dia. spring
steel clips to suit **Multicel C15**
or **Multicel C24** application.

3

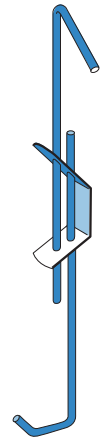

Butterfly suspension key hanger
with 4mm dia. steel hook rod
and 4mm dia. cranked rod.

Standard lengths: various
between 125mm min. and
1000mm max. ceiling void
depths.

4

Reference number allocation to
a component is based on its
function in the ceiling system.
No Multicel C or Multicel R
component suits 4 classification.

5

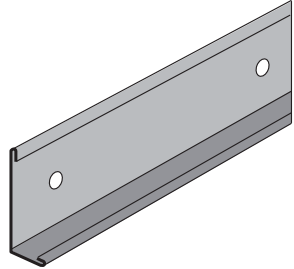

Perimeter angle trim in cold roll
formed 0.7mm thick aluminium
or 0.6mm thick steel.

Standard finish: stove enamel
polyester paint to match Multicel
C or Multicel R panels applied
to all surfaces.

Standard length: 4000mm

Overall size: 40mm deep x
20mm wide.

6

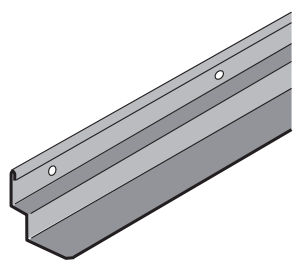

Perimeter shadow line angle trim
in cold roll formed 0.7mm thick
aluminium or 0.6mm thick steel.

Standard finish: stove enamel
polyester paint to match Multicel
C or Multicel R panels applied
to all surfaces.

Standard length: 4000mm

Overall size: 44mm deep x
36.5mm wide.

Shadow gap width 12.5mm.

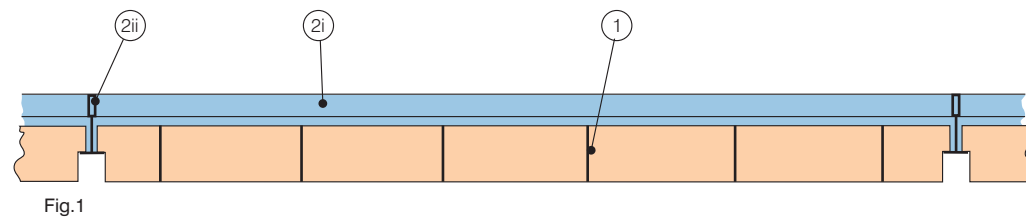

Fig.1

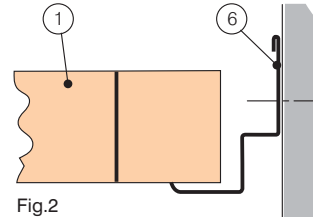

Fig.2

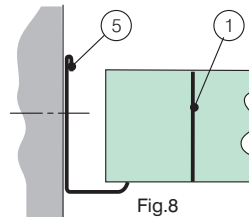

Fig.8

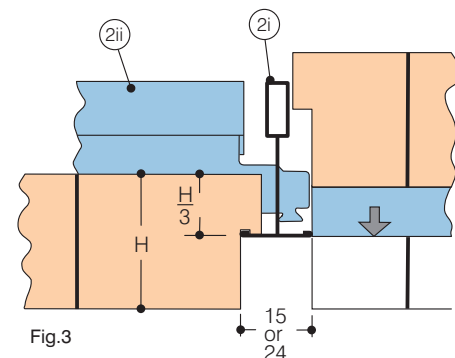

Fig.3

Featuring small square cell formations, Multicel louvre panels are available in a wide range of cell widths and heights

They are prefabricated from intersected single blades of painted aluminium or steel.

The standard 600 x 600mm or 600 x 1200mm panels are of two types:-

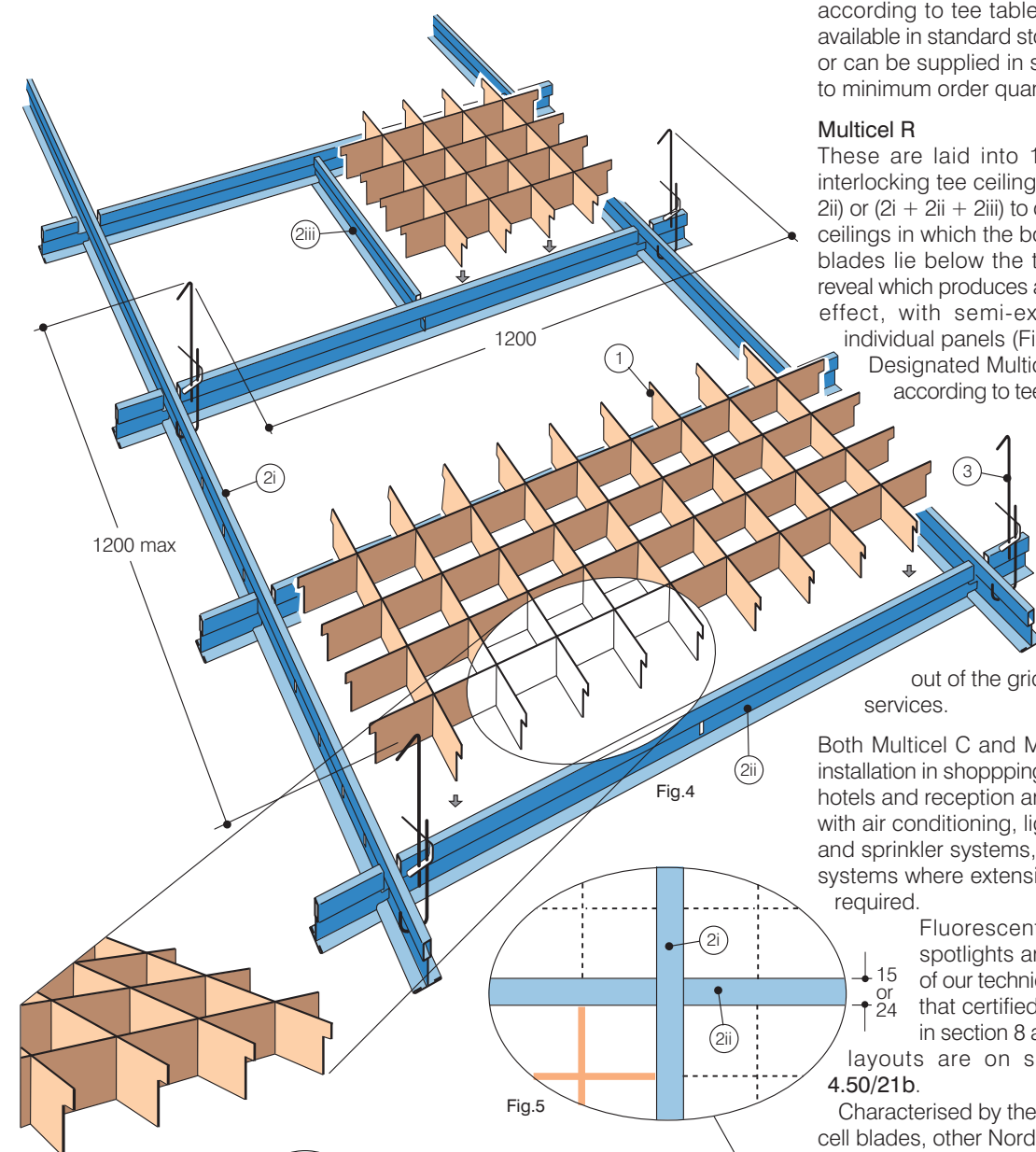

Fig.4

Multicel C

These are suspended by hook-on fixings (2A) (Figs.9-12) from 15mm or 24mm wide interlocking tee ceiling suspension grid (2i + 2ii) to create uniform continuous open cell louvred ceilings. They mask the grid and any infill material laid in it.

Released from the hooks, the panels can be taken straight down. This facilitates building services accessibility, unrestricted by any void clearance limitations.

Designated Multicel C15 or Multicel C24 according to tee table width, the panels are available in standard stove enamel white finish, or can be supplied in special finishes subject to minimum order quantity.

Multicel R

These are laid into 15mm or 24mm wide interlocking tee ceiling suspension grid (2i + 2ii) or (2i + 2ii + 2iii) to create open cell louvred ceilings in which the bottom edges of the cell blades lie below the tee face. This forms a reveal which produces a discontinuous louvred effect, with semi-exposed tees framing individual panels (Figs.3-7).

Designated Multicel R15 or Multicel R24 according to tee table width, the panels are available in standard stove enamel white finish, or can be supplied in special finishes subject to minimum order quantity.

Demonstrably quick to install, the panels can be easily lifted out of the grid for access to building services.

Both Multicel C and Multicel R are suited to installation in shopping malls, banks, airports, hotels and reception areas and for integration with air conditioning, lighting, communication and sprinkler systems, plus smoke extraction systems where extensive open cell areas are required.

Fluorescent lighting fittings and spotlights are featured in section 6 of our technical manual. Please note that certified performance data are in section 8 and typical specification layouts are on sheets 4.50/21a and 4.50/21b.

Characterised by their 'U' or Delta formation cell blades, other NordProfil open cell ceilings make up the Gridal product group, and are featured on the following information sheets 4.01, 4.01/1, 4.02, 4.03, 4.05, 4.06, 4.07.

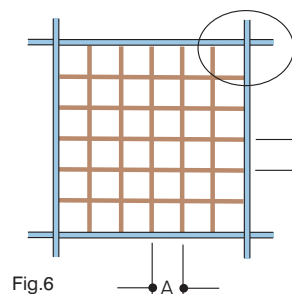

Fig.6

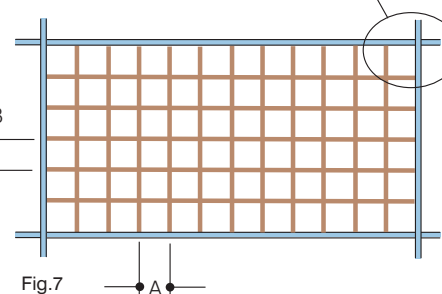

Fig.7

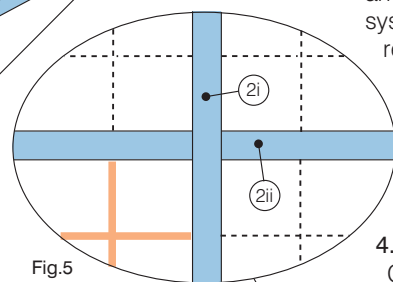

Fig.5

Multicel R

Multicel C & Multicel R

Suspended from the structural soffit by adjustable hangers (3) main runner tees (2i) are accurately positioned, aligned and levelled at 1200mm centres. For ease of linking the tee ends are extended to act as an interlocking splice. For fast fit assembly their stalks contain cutouts into which the ends of lateral tees (2ii) are mechanically locked.

Multicel C only

For 600 x 1200mm panels lateral runners are installed at 1200mm centres, for 600 x 600mm panels, at 600mm centres.

Hook-on clips (2A) shall be positioned over the tees at each corner of the panel, each serving to support two adjacent panels by locating the clip's horizontal legs in the outer blades' holes (for quantity take off purposes 2 clips per panel). Alignment clips (1A) shall link adjacent panels near to each corner by location over the panel blades (for quantity take off purposes 4 clips per panel).

Multicel R only

Lateral runners are installed at 600mm centres for 600 x 1200mm panels, plus cross tees (2iii) locked into their central cutouts to suit 600 x 600mm panels.

Laid into the tee grid, Multicel R panel's rebated ends must make even contact with the table of the tees.

The minimum void depth to install Multicel R panels is 150mm.

Either of the perimeter angles (5) (Fig. 8) and (6) (Fig. 2) can be used to cloak Multicel C or Multicel R cut components at wall and other abutments.

Table 1 Multicel C & R cell dimensions, weights and light angles.

A Cell dimension as Fig. 6, 7, 13 & 14 in mm
B Cell dimension as Fig. 6, 7, 13 & 14 in mm
Wa Ceiling weights (alu. 0.5mm) kg/m²
Ws Ceiling weights (stl. 0.4mm) kg/m² H Cell height in mm L Light angle°

A	B	H	L	Wa	Ws
15	15	15	45	2.70	6.40
20	20	15	37	2.00	4.80
20	20	20	45	2.70	6.40
20	20	30	56	4.10	9.60
25	25	20	39	2.20	5.10
25	25	25	45	2.70	6.40
25	25	30	50	3.20	7.70
30	30	20	34	1.80	4.30
30	30	25	40	2.25	5.30
30	30	30	45	2.70	6.40
40	40	20	27	1.35	3.20
40	40	25	32	1.70	4.00
40	40	30	37	2.00	4.80
40	40	40	45	2.70	6.40
45	45	45	45	2.70	6.40
50	50	25	27	1.35	3.20
50	50	30	31	1.60	3.80
50	50	35	35	1.90	4.50
50	50	40	39	2.20	5.10
50	50	50	45	2.70	6.40

Note: above weights exclude weights of tee grids = 1.2kg/m²

Multicel C

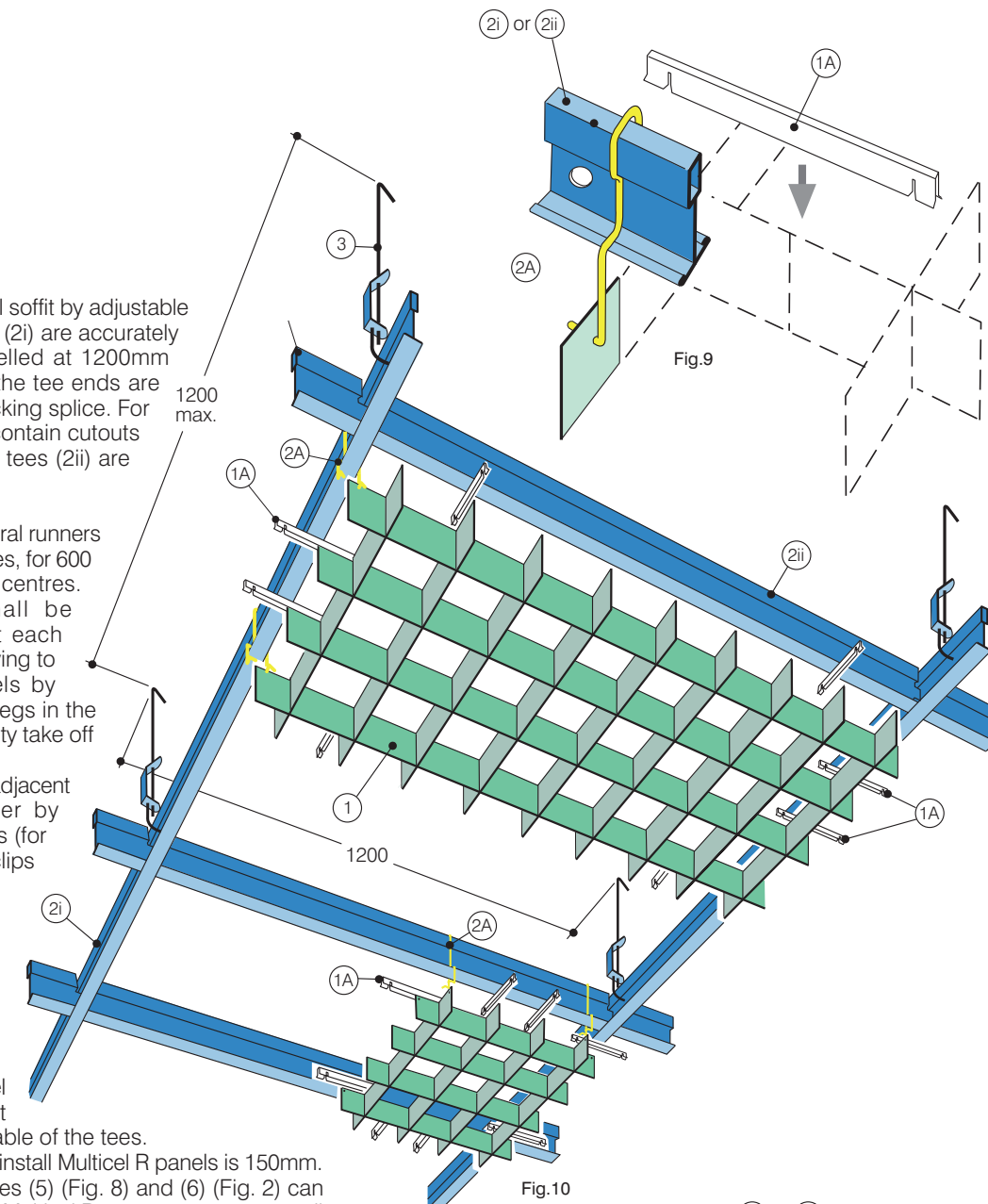

Fig.10

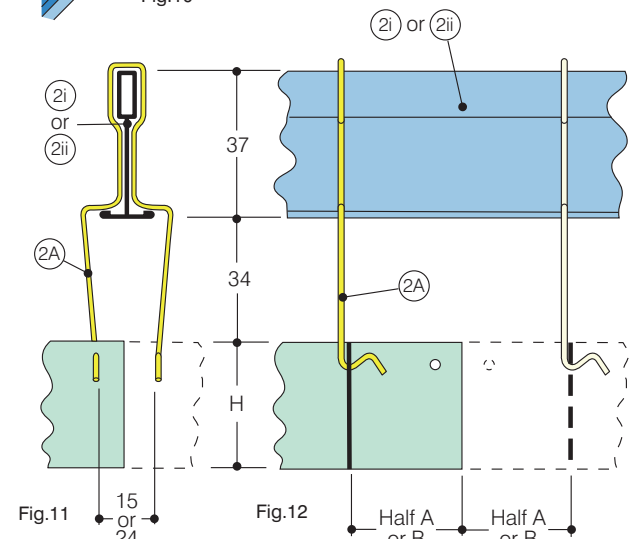

Fig.11

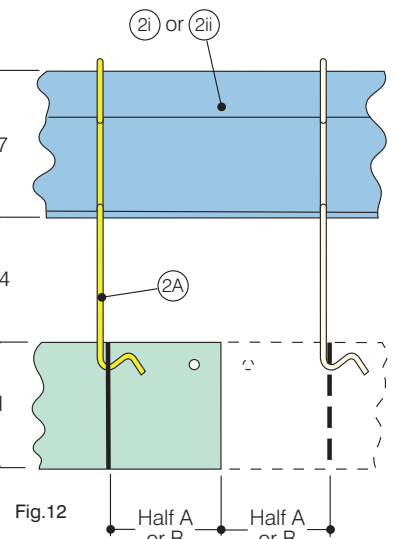

Fig.12

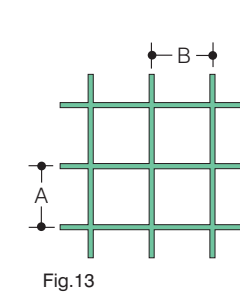

Fig.13

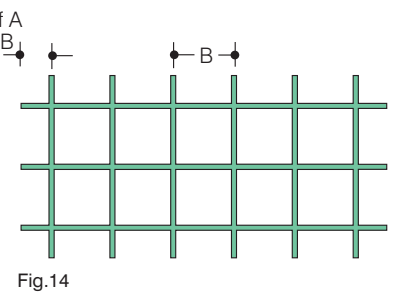

Fig.14